



BYLAW NO. 25-1005
of the Municipal District of Greenview No. 16

A Bylaw of the Municipal District of Greenview No. 16, in the Province of Alberta, to amend Bylaw No. 25-1000, being the Land Use Bylaw for the Municipal District of Greenview No. 16

WHEREAS, the Municipal Government Act, being Chapter M-26, R.S.A. 2000, as amended, authorizes the Council of the Municipal District of Greenview No. 16 to establish and amend Land Use Bylaw No. 25-1000.

AND WHEREAS, the Council of the Municipal District of Greenview No. 16 has deemed it desirable to amend the Land Use Bylaw No. 25-1000.

NOW, THEREFORE, the Council of the Municipal District of Greenview No. 16, duly assembled, enacts as follows:

1. That Map No. 13 in the Land Use Bylaw, being Bylaw No. 25-1000, be amended to reclassify the following area:

All that Portion of the
Southeast (SE) Quarter of Section Thirty-Three (33)
Within Township Sixty-Nine (69)
Range Seven (7) West of the Sixth Meridian (W6M)

As identified on Schedule "A" attached.

This Bylaw shall come into force and effect upon the day of third and final reading.

Read a first time this 25 day of November, A.D., 2025.

Read a second time this 13 day of January, A.D., 2026.

Read a third time and passed this 13 day of January, A.D. 2026.



REEVE



CHIEF ADMINISTRATIVE OFFICER



SCHEDULE "A"

BYLAW NO. 25-1005

MUNICIPAL DISTRICT OF GREENVIEW NO. 16

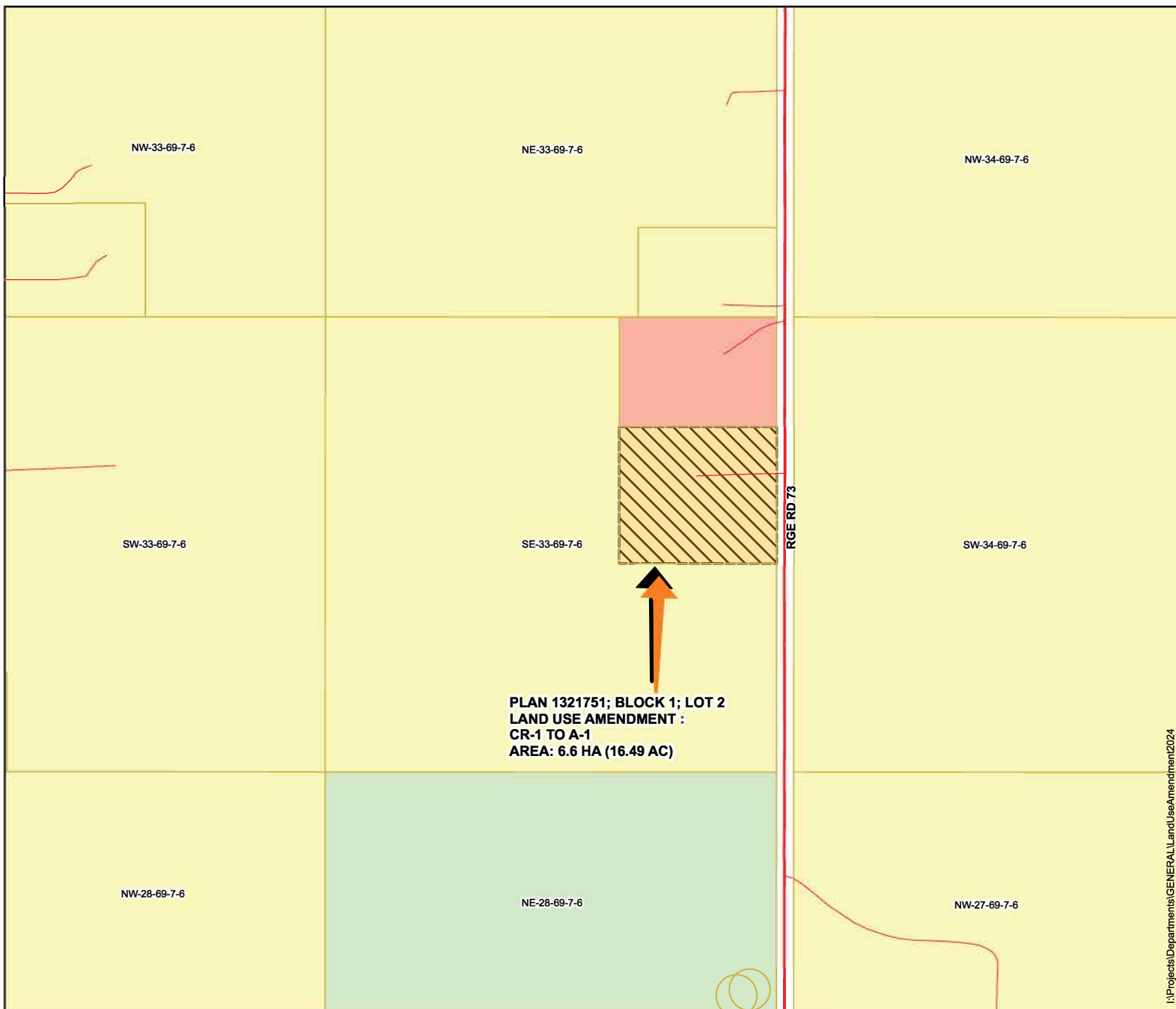

\\Projects\Departments\GENERAL\Land Use\Amendmen2024

LEGEND



A-1



Country Residential One (CR-1)

ZONING TYPE



Agricultural One (A-1)



Crown Land (CL)

TRANSPORTATION



Municipal-Gravel



Private-Gravel

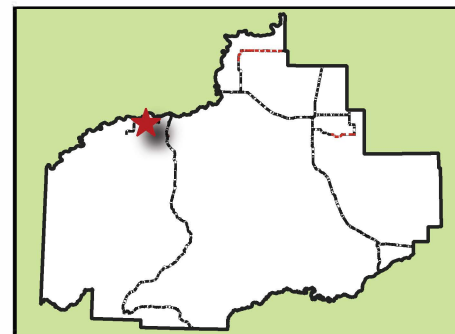

DISCLAIMER:
 Persons using this document do so solely at their own risk, and Municipal District of Greenview No. 16 shall have no liability to such persons for any loss or damage whatsoever. This document shall not be copied or distributed to any person without the express written consent of Municipal District of Greenview No. 16.
 © 2025 Municipal District of Greenview No. 16. All Rights Reserved. NOT RESPONSIBLE FOR ERRORS OR OMISSIONS

Map Print Date : October 24, 2025
 Created by: M.D. of Greenview No.16 - GIS Department.

0 200 400



METRES
 SCALE 1:10000